

FLOOR 1

UWMC Floor Maps for Patients and Visitors

January 2016

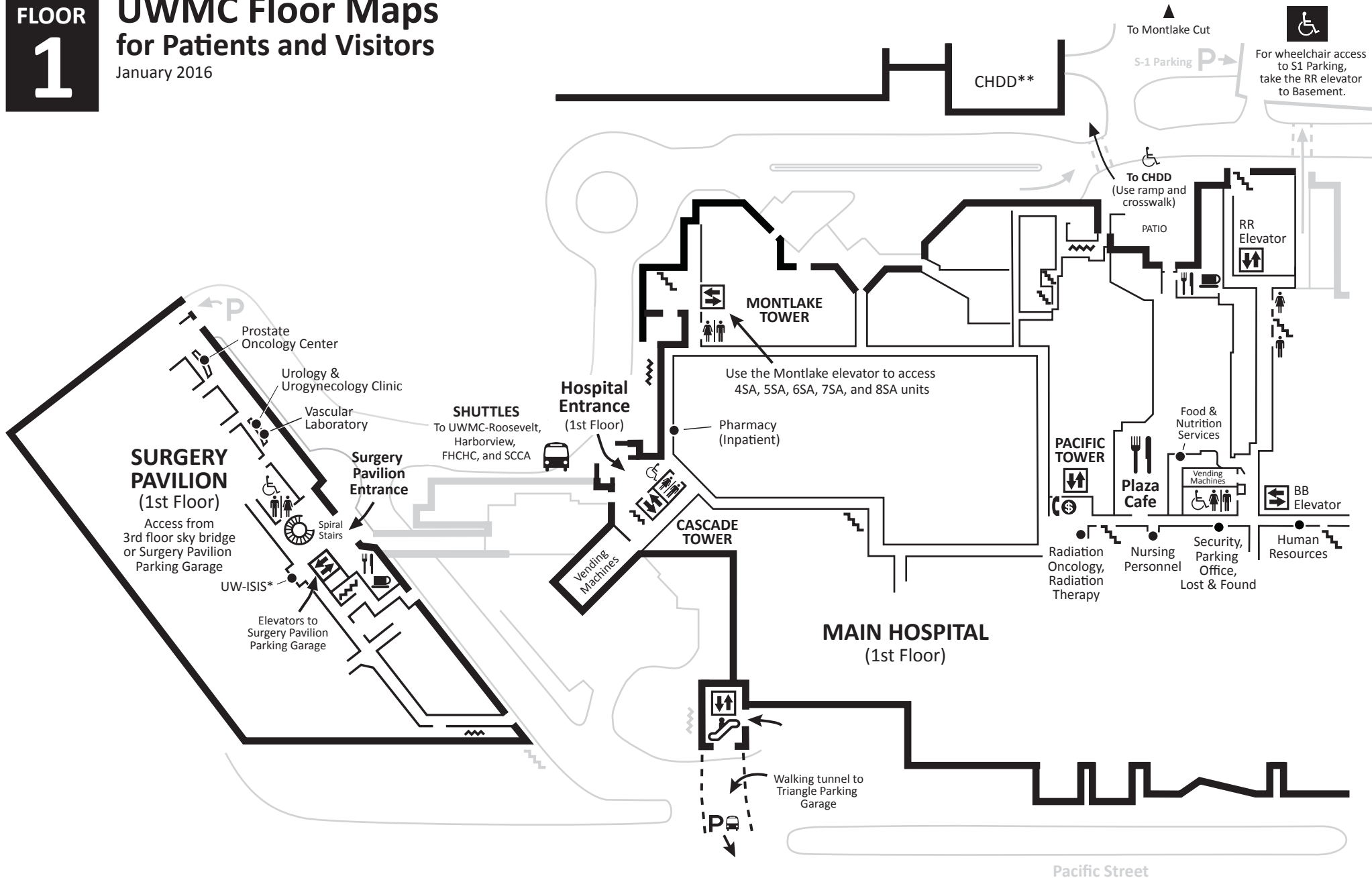

KEY	Shuttle	Elevator	Food	Phone
	Cash machine (1st Floor)	Escalator	Restrooms	TTY phone
	Coffee (1st & 3rd Floors)	Parking	Stairs	Wheelchair access

NOTES

* **UW-ISIS** = University of Washington Institute for Simulation and Interprofessional Studies.

** **CHDD** = Center on Human Development and Disability. The Genetic Medicine Clinic is in the CHDD weekdays from 8 a.m. to 5 p.m.

UW Medicine
 UNIVERSITY OF WASHINGTON
 MEDICAL CENTER
 UH1648 (Rev. 01/2016) - MapUWMC/Floor 1
 UH1647 (Rev. 01/2016) - MapUWMC/All Floors

UWMC Floor Maps for Patients and Visitors

January 2016



For wheelchair access to S1 Parking, take the RR elevator to Basement.

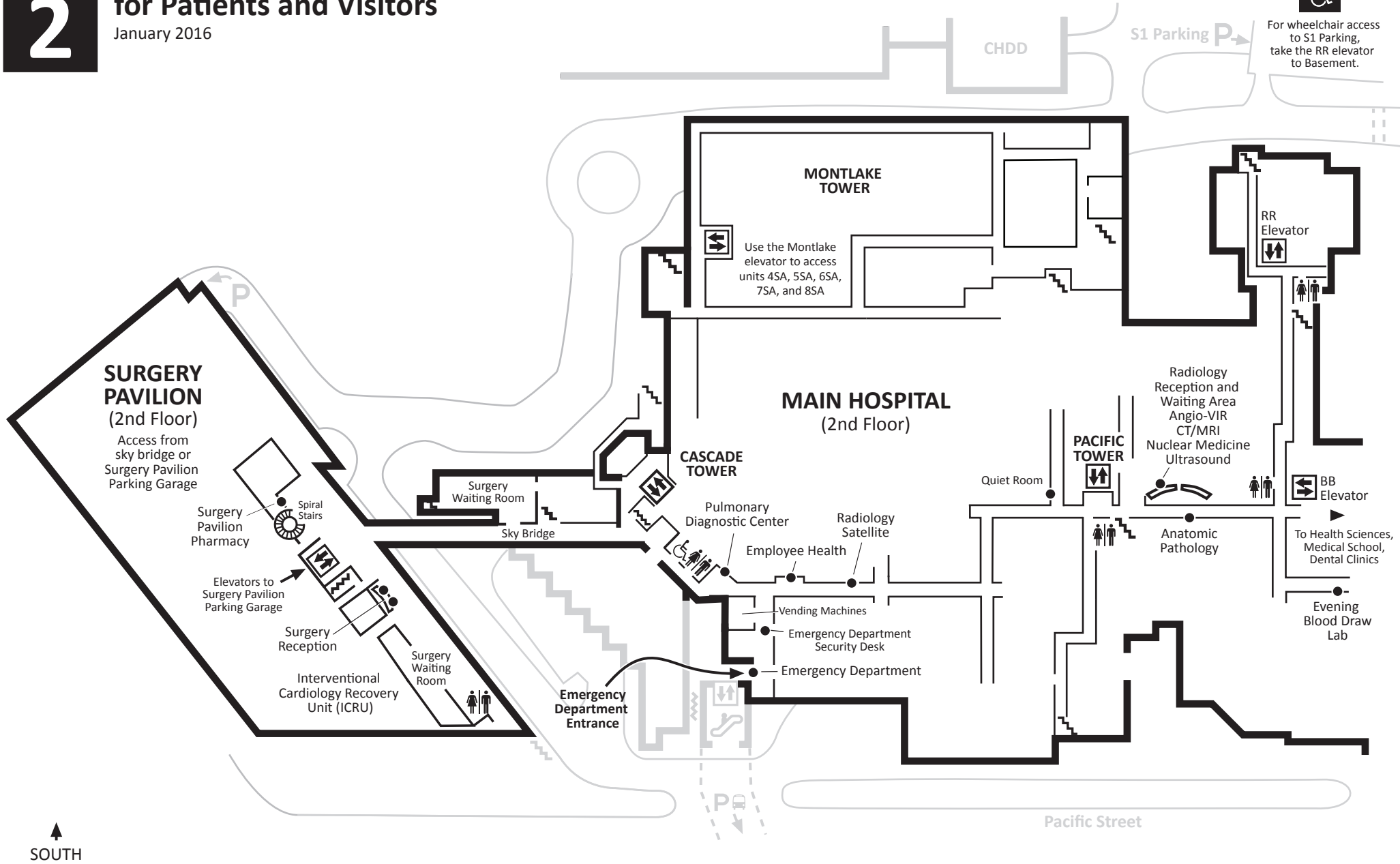

KEY	NOTES
Shuttle	Elevator
Cash machine (1st Floor)	Escalator
Coffee (1st & 3rd Floors)	Restrooms
Parking	Stairs
Phone	Wheelchair access
TTY phone	
Food	

FLOOR 3

UWMC Floor Maps for Patients and Visitors

January 2016

Floor 3 is the main level of the hospital



For wheelchair access to S1 Parking, take the RR elevator to Basement.

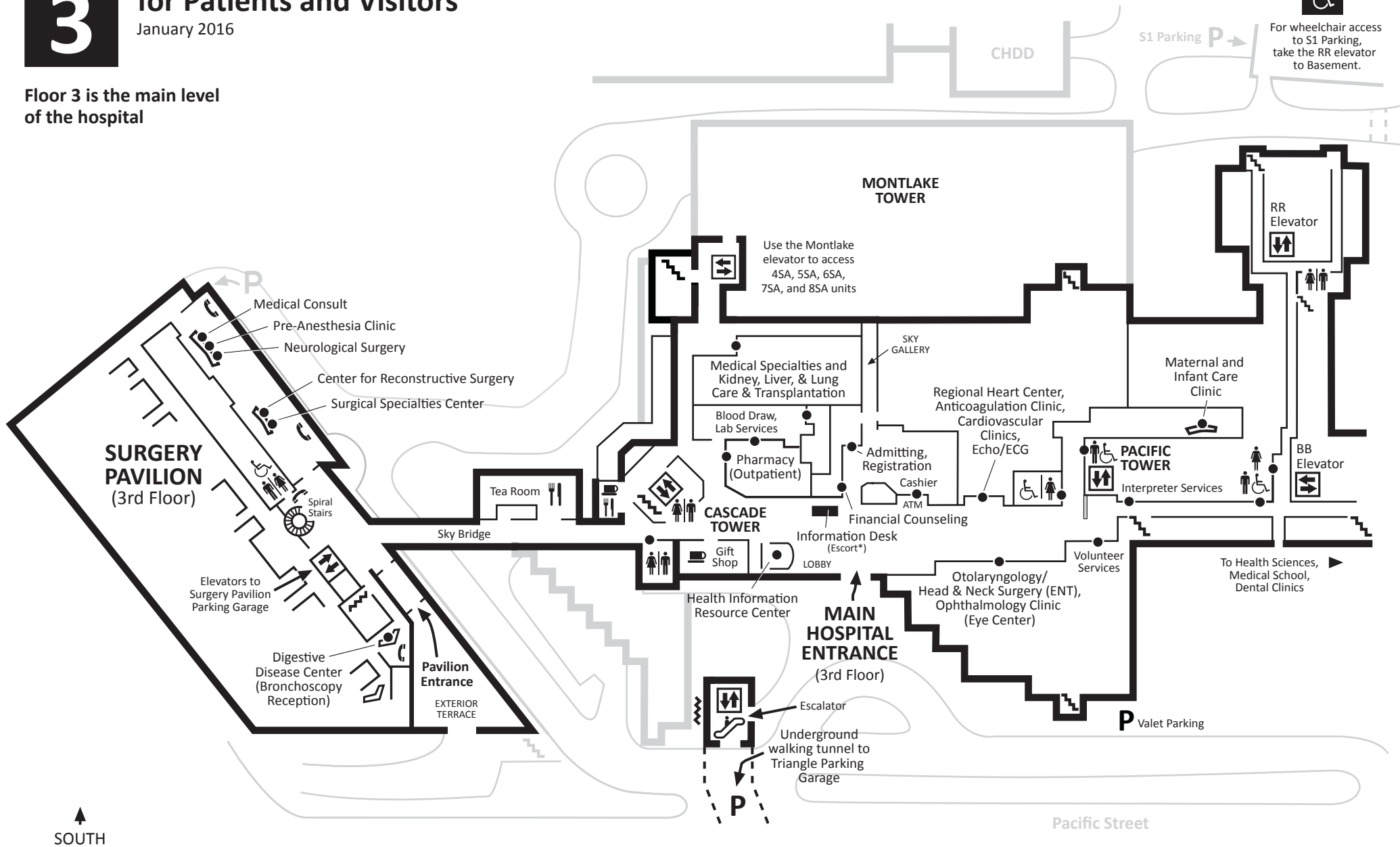

KEY

- Shuttle
- Elevator
- Food
- Phone
- Cash machine (1st Floor)
- Escalator
- Restrooms
- TTY phone
- Coffee (1st & 3rd Floors)
- Parking
- Stairs
- Wheelchair access

NOTES

The index of locations on this map is available in several non-English languages. Ask at the Information Desk or the Health Information Resource Center in the main lobby on the 3rd floor.

* For staff escort after hours, call 598-5555.

UW Medicine
UNIVERSITY OF WASHINGTON
MEDICAL CENTER

UH1650 (Rev. 01/2016) - MapUWMC/Floor 3
UH1647 (Rev. 01/2016) - MapUWMC/All Floors

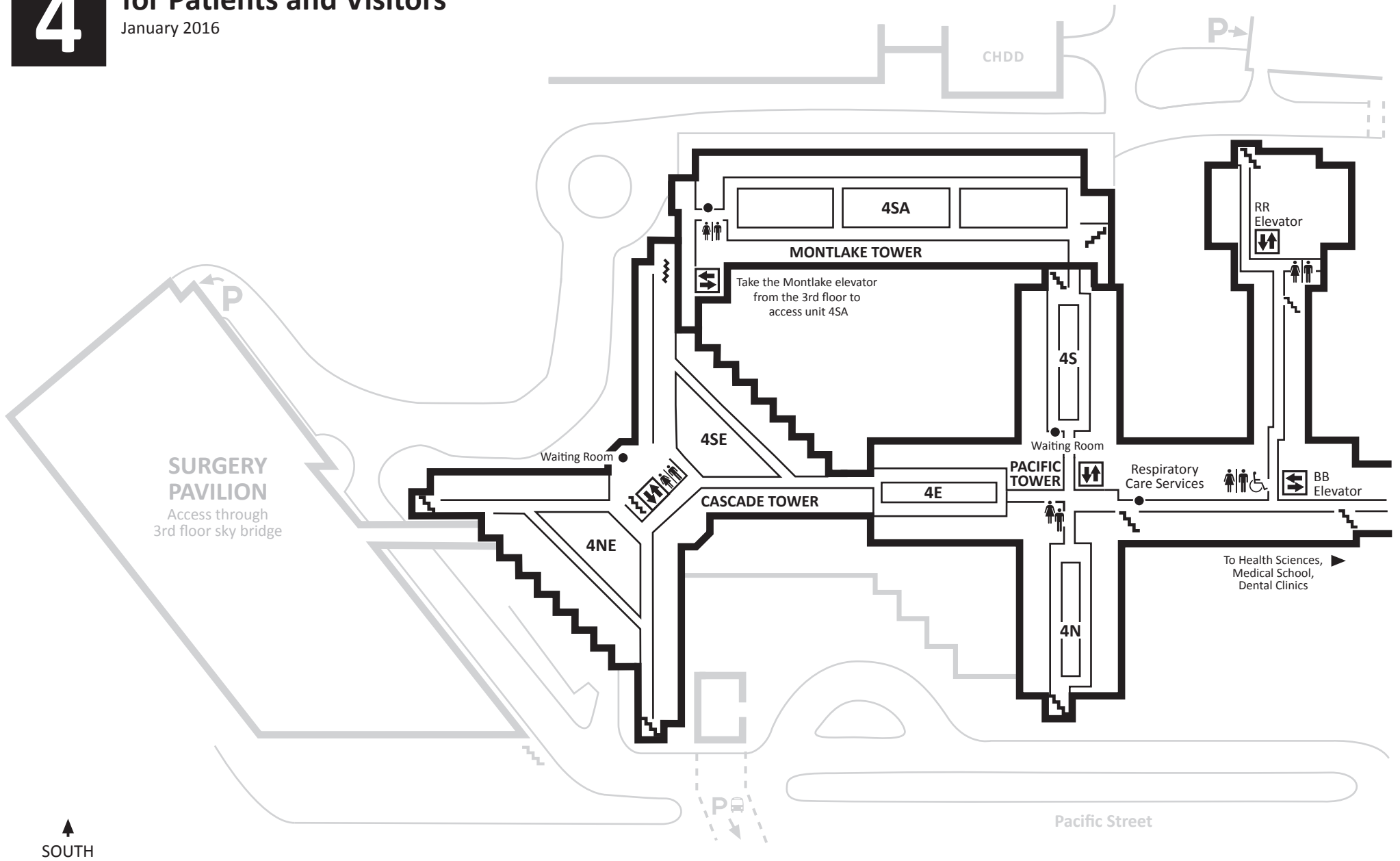

KEY

- | | | | | | | | |
|--|---------------------------|--|-----------|--|-----------|--|-------------------|
| | Shuttle | | Elevator | | Food | | Phone |
| | Cash machine (1st Floor) | | Escalator | | Restrooms | | TTY phone |
| | Coffee (1st & 3rd Floors) | | Parking | | Stairs | | Wheelchair access |

NOTES

UWMC Floor Maps for Patients and Visitors

January 2016

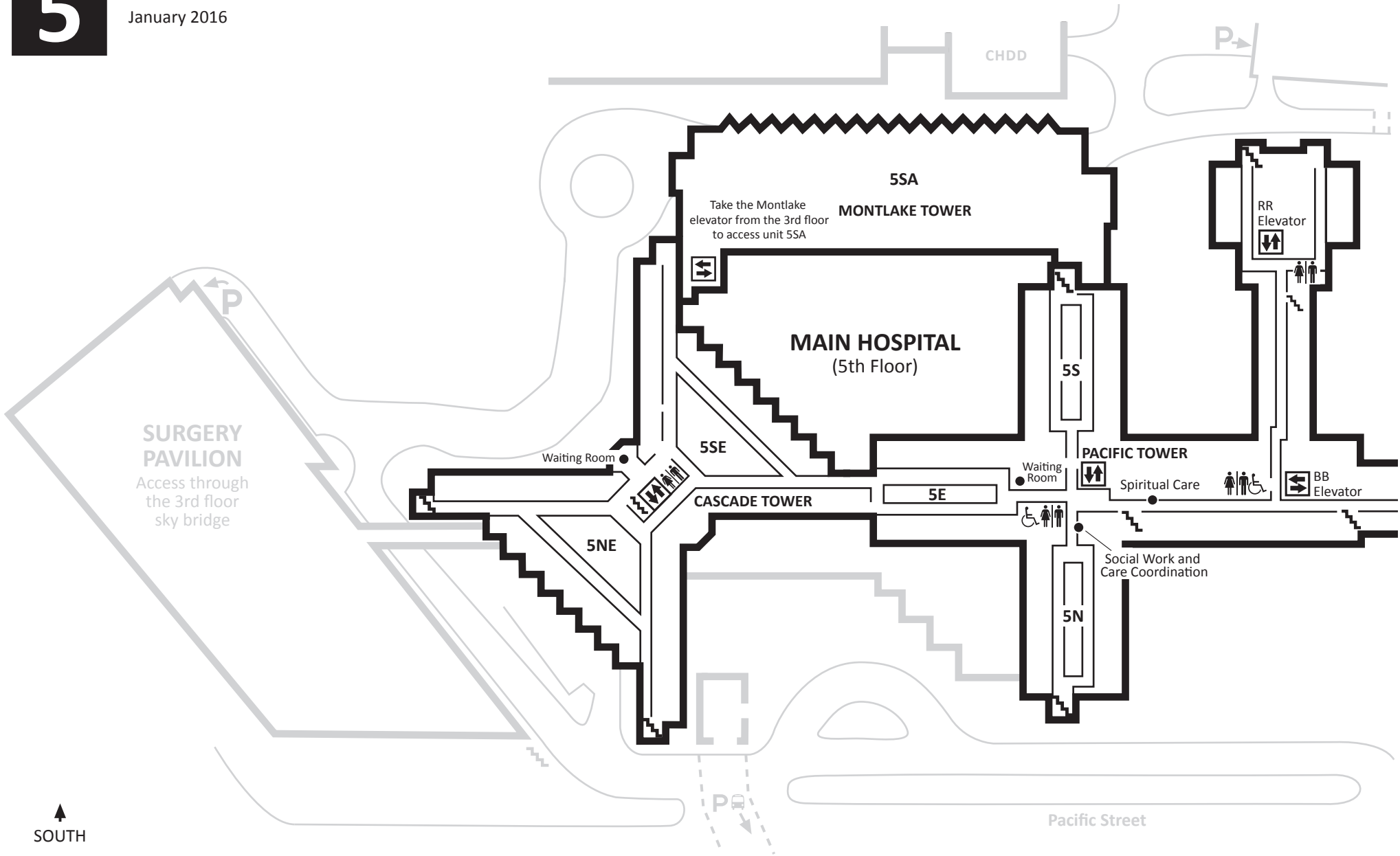

KEY

- | | | | | | | | |
|--|---------------------------|--|-----------|--|-----------|--|-------------------|
| | Shuttle | | Elevator | | Food | | Phone |
| | Cash machine (1st Floor) | | Escalator | | Restrooms | | TTY phone |
| | Coffee (1st & 3rd Floors) | | Parking | | Stairs | | Wheelchair access |

NOTES

FLOOR 6

UWMC Floor Maps for Patients and Visitors

January 2016

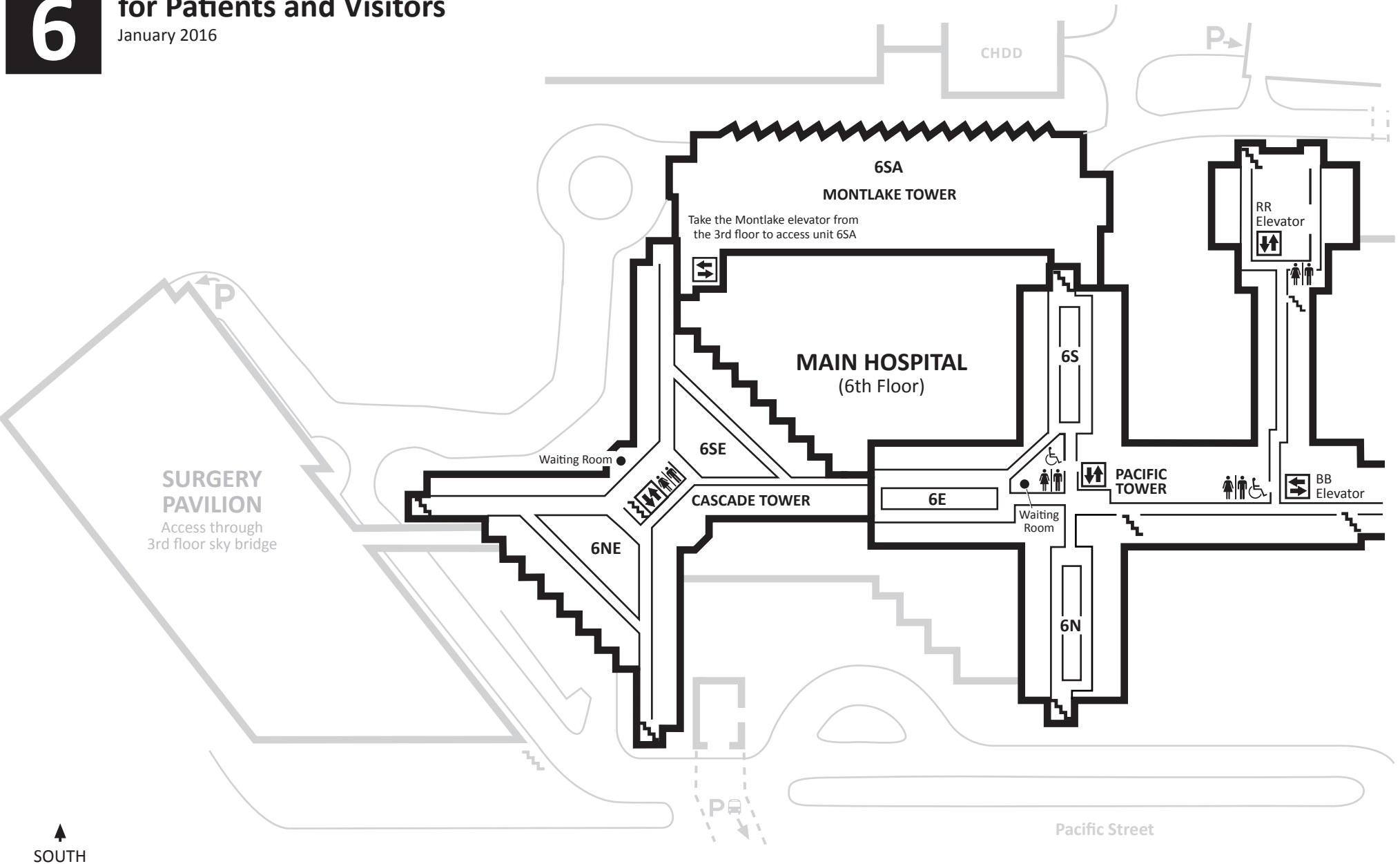

↑
SOUTH

KEY	NOTES
Shuttle	Phone
Cash machine (1st Floor)	Restrooms
Coffee (1st & 3rd Floors)	Stairs
Elevator	TTY phone
Escalator	Wheelchair access
Parking	
Food	

FLOOR
7

UWMC Floor Maps for Patients and Visitors

January 2016

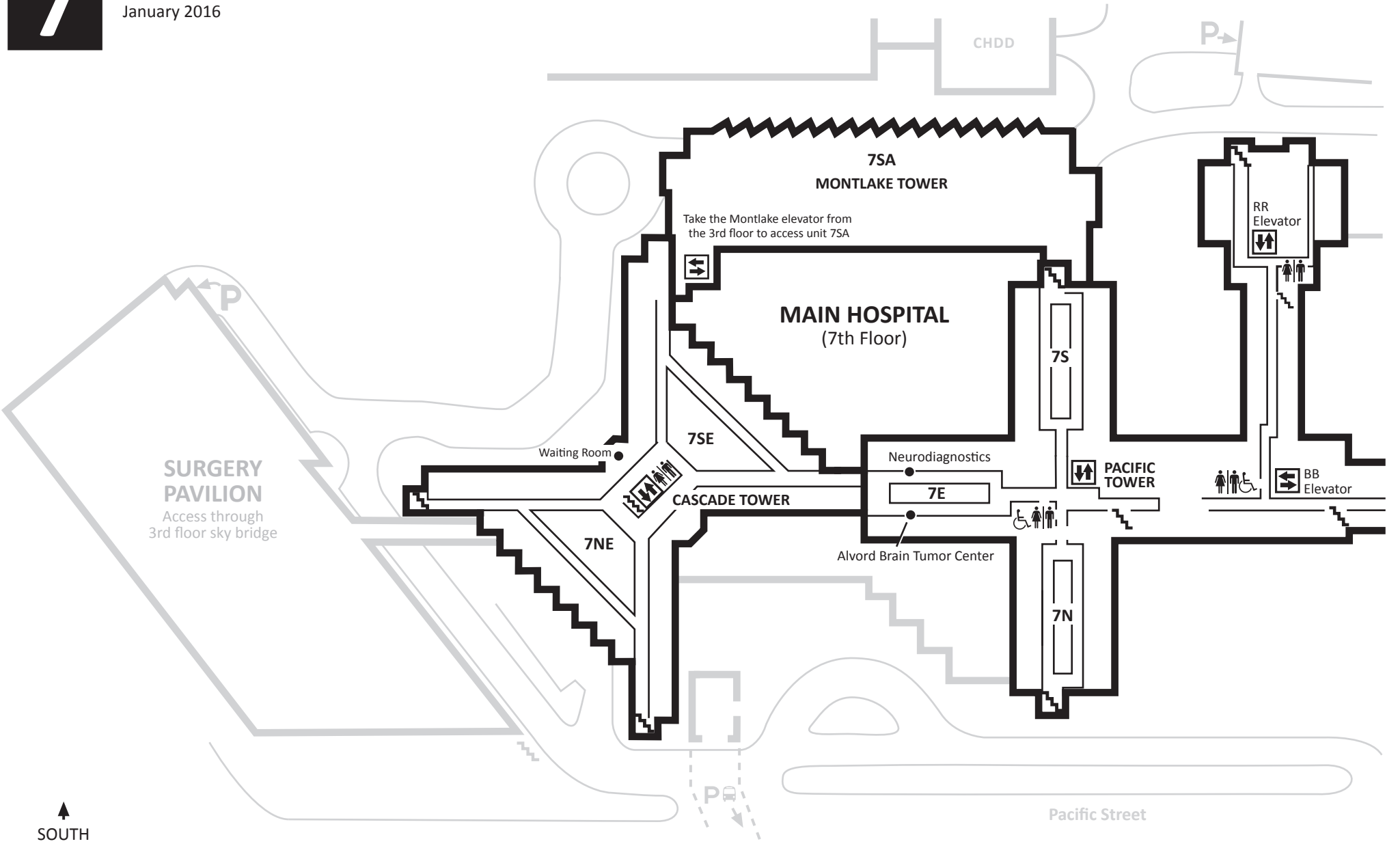

KEY	SHUTTLE	ELEVATOR	FOOD	PHONE
				Shuttle
				Cash machine (1st Floor)
				Coffee (1st & 3rd Floors)

NOTES

UW Medicine
UNIVERSITY OF WASHINGTON
MEDICAL CENTER

UH1654 (Rev. 01/2016) - MapUWMC/Floor 7
UH1647 (Rev. 01/2016) - MapUWMC/All Floors

UWMC Floor Maps for Patients and Visitors

January 2016

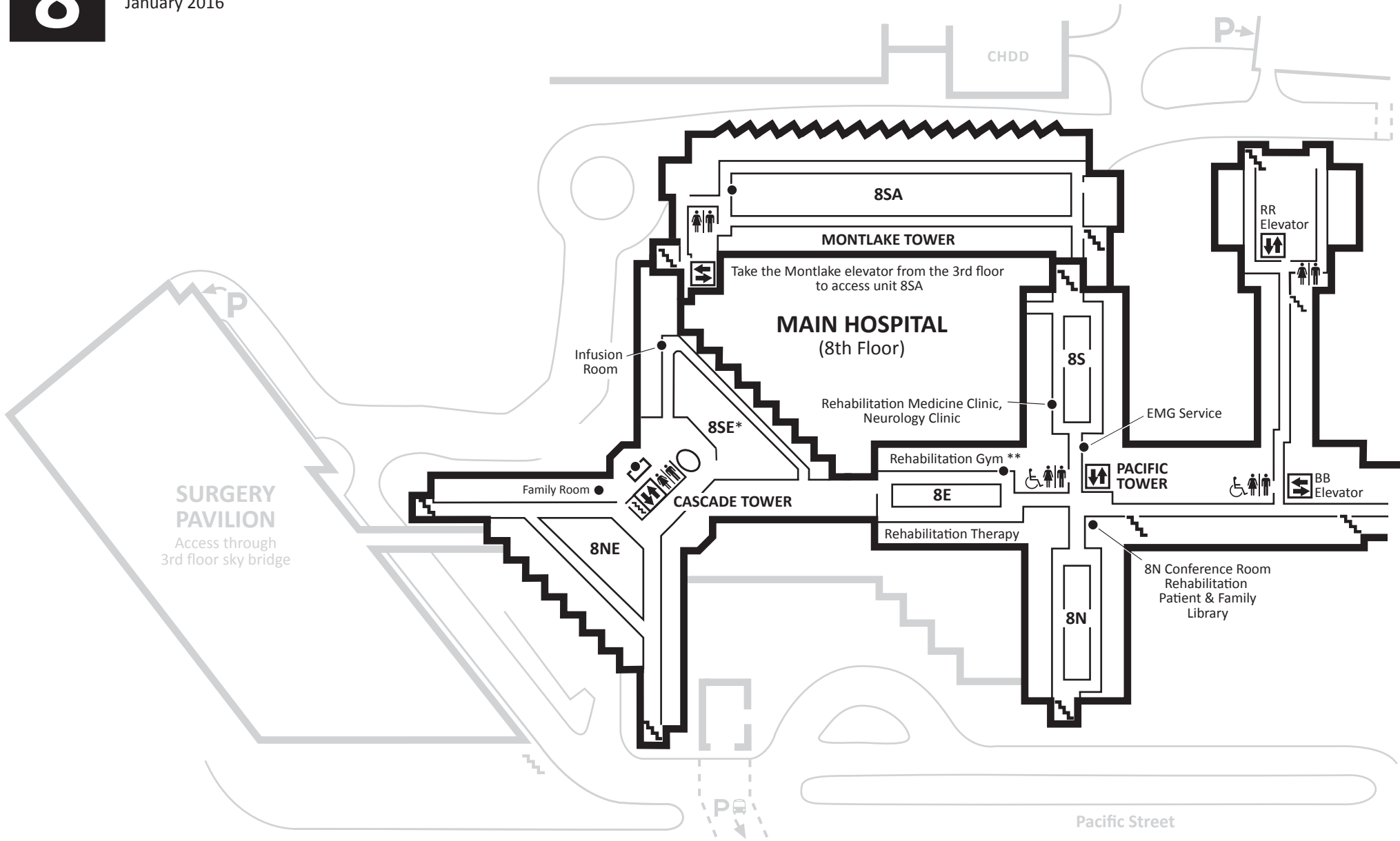

KEY

- | | | | |
|---------------------------|-----------|-----------|-------------------|
| Shuttle | Elevator | Food | Phone |
| Cash machine (1st Floor) | Escalator | Restrooms | TTY phone |
| Coffee (1st & 3rd Floors) | Parking | Stairs | Wheelchair access |

NOTES

- * Clinics on 8SE include the Infusion Clinic, the Oncology Clinic, and Medical Specialties/Transplant Satellite Clinics
- ** Rehabilitation Gym includes OT, PT, ST, and Rehabilitation Counseling

UW Medicine
UNIVERSITY OF WASHINGTON
MEDICAL CENTER

Index for UWMC Floor Maps

January 2016

Department/Area	Phone
8N Conference Room (8th floor)	598-4800
Admitting (3rd floor)	598-4310
Alvord Brain Tumor Center (7th floor)	598-2282
Anatomic Pathology (2nd floor)	598-6400
Angio-VIR (2nd floor)	598-6200
Anticoagulation Clinic (3rd floor)	598-4874
Blood Draw Lab Services (3rd floor)	598-6153
Bronchoscopy (SP, 3rd floor)	598-7431
Cafeteria (Plaza Café, 1st floor)	
Cardiac Surgery, Thoracic Surgery, Cardiology	598-4500
Cardio/Thoracic ICU	598-6500
Cardio/Thoracic Surgery	598-4500
Cardiovascular Clinics (3rd floor)	598-4300
Cashier (3rd floor)	598-4187
Center for Reconstructive Surgery (3rd floor)	598-4477
CHDD	598-4317
Clinical Research Center	598-4730
CT/MRI (2nd floor)	598-6200
Digestive Disease Center (SP)	598-4377
Echo/ECG (Regional Heart Center)	598-7000
Emergency Department	598-4000
Emergency Department Security Desk	598-5555
EMG Service (8th floor)	598-4828
Employee Health (2nd floor)	598-4848
Escort Services (3rd floor)	598-4457
Escort for Staff (after hours)	598-5555
Evening Blood Draw Lab (2nd floor)	598-6224
Family Medicine Units	598-6800
Financial Counseling (3rd floor)	598-4320
Food & Nutrition Services (1st floor)	598-4151
General Medicine Unit	598-6800
General Surgery Unit	598-4422
Genetic Medicine Clinic (CHDD)	598-4030
Gift Shop (3rd floor)	598-4900
Gynecologic Oncology Unit	598-4818
Health Information Resource Center (3rd floor)	598-7960
Hematologic Oncology Unit	598-4818
Hematology	598-7770
HSCT Transplant Unit	598-7770
HSCT Transplant/Oncology ICU	598-8902
Human Resources (1st floor)	598-6116
ICU/Transplant ICU	598-4545
Information Desk (3rd floor)	598-6555
Infusion Room (8th floor)	598-4296
Interpreter Services (3rd floor)	598-4425
Interventional Cardiology Recovery Unit (ICRU)	598-7146
Kidney Care/Transplant (3rd floor)	598-8881
Kidney Dialysis Unit	598-4400
Labor & Delivery Unit	598-4616
Labor & Delivery Antepartum Unit	598-4616
Liver Care/Transplant (3rd floor)	598-8882
Lost & Found (1st floor)	598-4909
Lung Care (3rd floor)	598-4615
Lung Transplant (3rd floor)	598-5668
Maternal & Infant Care Center (3rd floor)	598-4070
Medical Consult Service (SP)	598-5160
Medical Specialties Center (3rd floor)	598-4615
Mother-Baby Unit	598-5600
Neonatal Intensive Care Unit	598-4606

Department/Area	Phone
Neurodiagnostics (7th floor)	598-4211
Neurological Surgery (SP, 3rd floor)	598-5637
Neurology Clinic (8th floor)	598-7688
Neurology Unit	598-4422
Neurosurgery Unit	598-4422
Nuclear Medicine Clinic (2nd floor)	598-6200
Nursing Personnel (1st floor)	598-4480
Nutrition Clinic (7th floor)	598-6004
Oncology (6th floor)	598-4410
Oncology (7th floor)	598-7770
Oncology Inpatient Unit	598-0700
Oncology Concierge Desk	598-3972
Oncology Pharmacy (8th floor)	598-3895
Operator (UWMC)	598-3300
Ophthalmology Clinic (Eye Center) (3rd floor)	598-4022
Orthopaedics Unit	598-4410
Otolaryngology Unit	598-4422
Otolaryngology/Head & Neck Surgery/ENT (3rd floor)	598-4022
Parking Office (1st floor)	598-5275
Pharmacy - Inpatient (1st floor)	598-4088
Pharmacy - Outpatient (3rd floor)	598-4364
Pharmacy - Surgery Pavilion (2nd floor)	598-9949
Pre-Anesthesia Clinic (SP, 3rd floor)	598-5053
Prostate Oncology Center (SP, 1st floor)	598-6088
Psychiatric Unit - Inpatient	598-4720
Pulmonary Diagnostic Center (2nd floor)	598-4265
Quiet Room (2nd floor)	
Radiation Oncology/Radiation Therapy (1st floor)	598-4100
Radiology (2nd floor)	598-6200
Radiology Satellite (2nd floor)	598-6200
Regional Heart Center (3rd floor)	598-4300
Registration (3rd floor)	598-4310
Rehabilitation Patient & Family Library (8th floor)	598-4800
Rehabilitation Gym (8th floor)	598-4830
Rehabilitation Medicine Clinic (8th floor)	598-4295
Rehabilitation Therapy (8th floor)	598-4830
Rehabilitation Unit - Inpatient	598-4800
Renal Medicine Unit	598-4400
Respiratory Care Services (4th floor)	598-4444
Security Office (1st floor)	598-4909
Social Work & Care Coordination (5th floor)	598-4370
Special Procedures Unit	598-4670
Spiritual Care (5th floor)	598-9174
Surgery Reception (SP, 2nd floor)	598-9800
Surgery Waiting Room (SP, 2nd floor)	598-9800
Surgery Waiting Room (SB, 2nd floor)	598-9953
Surgical Specialties Clinic (SP, 3rd floor)	598-4477
Tea Room (SB, 3rd floor)	598-9891
Transplant ICU	598-4545
Transplant Surgery Unit	598-4400
Ultrasound (2nd floor)	598-6211
Urology (SP, 1st floor)	598-4818
Urology & Urogynecology Clinic (SP, 1st floor)	598-4294
UW-ISIS (SP, 1st floor)	598-2710
Vascular Laboratory (SP, 1st floor)	598-4449
Vascular Surgery	598-4400
Volunteer Services (3rd floor)	598-4218

North, South & East Units: Use Pacific elevators
Northeast & Southeast Units: Use Cascade elevators

SP = Surgery Pavilion
SB = Sky Bridge